

# **BIXOLON**

## **User's Manual**

# **SRP-S3000**

---

## **LINERLESS PRINTER**

### **Ver. 2.01**



[www.bixolon.com](http://www.bixolon.com)

## Copyright

© BIXOLON Co., Ltd. All rights reserved.

This user manual and all property of the product are protected under copyright law. It is strictly prohibited to copy, store, and transmit the whole or any part of the manual and any property of the product without the prior written approval of BIXOLON Co., Ltd. The information contained herein is designed only for use with this BIXOLON product. BIXOLON is not responsible for any direct or indirect damages, arising from or related to use of this information.

- The BIXOLON logo is the registered trademark of BIXOLON Co., Ltd.
- All other brand or product names are trademarks of their respective companies or organizations.

BIXOLON maintains ongoing efforts to enhance and upgrade the functions and quality of all our products.

In the following, product specifications and/or user manual content may be changed without prior notice.

## Caution

Electronics, such as printers, are prone to damage by static electricity. Therefore, to protect the printer from static electricity, be sure to turn off the printer before connecting or disconnecting the cable to the rear of the printer. If the printer is damaged by static electricity, contact your local dealer.

This equipment is not suitable for use in locations where children are likely to be present. When the printer is operating with the media cover open, do not wear anything that can touch the drive, such as clothing, necklaces, rings, watches, or employee certificates close to it. Also, keep yourself away from the printer as it is dangerous for some parts of the body to come into contact with it. If an object or part of your body touches the drive, immediately disconnect the power cord or turn off the power switch on the back of the product.

## Warning

Hazardous moving parts

Keep fingers and other body parts away

Pull the print head lever can be stop all moving parts.



IEC 60417-6057 (2011-05) for other moving parts.

## Mise en garde

Les appareils électroniques, tels que les imprimantes, risquent d'être endommagés par l'électricité statique. Par conséquent, pour protéger l'imprimante de l'électricité statique, veillez à l'éteindre avant de connecter ou de déconnecter le câble situé à l'arrière de celle-ci. Si l'imprimante est endommagée par l'électricité statique, contactez votre revendeur local

Cet appareil n'est pas adapté d'utiliser dans des endroits où des enfants sont probablement d'être présents.

Lorsque l'imprimante fonctionne avec le capot ouvert, ne portez rien qui puisse entrer en contact avec le mécanisme, tel que des vêtements, des colliers, des bagues, des montres ou des certificats d'employé à proximité. Éloignez-vous également de l'imprimante car il est dangereux que certaines parties du corps entrent en contact avec celle-ci. Si un objet ou une partie de votre corps entre en contact avec le mécanisme, débranchez immédiatement le câble d'alimentation ou éteignez l'interrupteur situé à l'arrière du produit.

## Attention

Pièces mobiles dangereuses

Veillez à ce que vos doigts ou toute partie du corps n'entre(nt) pas en contact avec ces pièces. Tirez le levier de la tête d'impression pour arrêter toutes les pièces en mouvement.



IEC 60417-6057 (2011-05) pour les autres pièces mobiles.

## Compliance information

This device complies with Part 15 of the FCC Rules. Operation is subject to the following two conditions: (1) This device may not cause harmful interference, and (2) This device must accept any interference received, including interference that may cause undesired operation.

This equipment has been tested and found to comply with the limits for a Class A digital device pursuant to Part 15 of the FCC Rules. These limits are designed to provide reasonable protection against harmful interference when the equipment is operated in a commercial environment. This equipment generates uses, and can radiate radio frequency energy and, if not installed and used in accordance with the instruction manual, may cause harmful interference to radio communications. Operation of this equipment in a residential area is likely to cause harmful interference in which case the user will be required to correct the interference at his own expense.

Caution: Exposure to Radio Frequency Radiation.

To comply with FCC RF exposure compliance requirements, a separation distance of at least 20 cm must be maintained between the antenna of this device and all persons.

Caution: Any Changes or modifications not expressly approved by the manufacturer could void the user's authority to operate the equipment.

Class A Digital Device: Wired Device

This Apparatus complies with class "A" limits for radio interference as specified in the Canadian department of communications radio interference regulations.

This Class A digital apparatus complies with Canadian ICES-003.

Appareil numérique de classe A: appareil filaire

Get appareil est conforme aux normes class "A" d'interference radio tel que specifier par ministre canadien des communications dans les reglements d'interference radio.

Cet appareil numérique de la classe A est conform à la norme NMB-003 du Canada.

## Waste Electrical and Electric Equipment (WEEE)



This marking shown on the product or its literature, indicates that it should not be disposed with other household wastes at the end of its working life. To prevent possible harm to the environment or human health from uncontrolled waste disposal, please separate this from other types of wastes and recycle it responsibly to promote the sustainable reuse of material resources. Household users should contact either the retailer where they purchased this product, or their local government office, for details of where and how they can take this item for environmentally safe recycling. Business users should contact their supplier and check the terms and conditions of the purchase contract. This product should not be mixed with other commercial wastes for disposal.



## WARNING & CAUTION

Is described as death, physical injuries, serious financial losses, and damage to data etc. that can be caused to the user.

Do not connect multiple products to a single or faulty power outlet. Use only grounded power outlets that meet the industry standard. **Noncompliance may cause electric shock or fire.**



Only use authentic products from BIXOLON. The company will not provide post-sale support for damaged or other quality issues that any fake (or refurbished) products may incur.



Do not excessively bend or strain the power cord. Securely push the power cord all the way into the power outlet lest it remain loose. Make sure to hold the cord tight when separating it from the power outlet. Do not remove the power cord while the product is in use. **Noncompliance may cause electric shock or fire.**

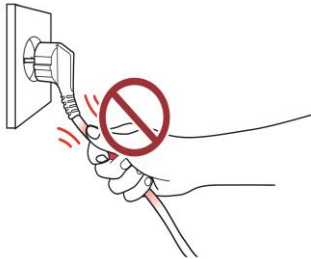

Keep small accessories or other packaging materials away from young children. Beware: choking hazard. **Mishandling the product may incur injuries which may require seeking urgent medical attention.**



SNOCK OR TIRE.

duct to be  
bjects.  
cause electric

Keep excessive liquids away from the power cord and outlet. If matter is smeared onto the power cords, wipe with a dry cloth. **Noncompliance may cause electric shock or fire.**

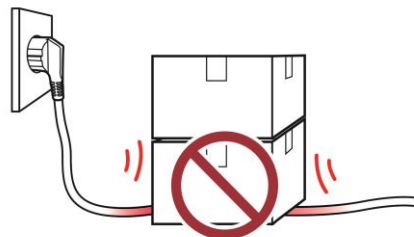
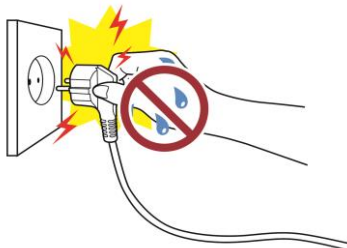

If the product emits a strange sound, burning smell, or smoke, turn off the power immediately and unplug the power cord. If the product is dropped or its exterior is damaged, turn off the power immediately and unplug the power cord. Do not subject the product to shock. **It may start a fire. It may damage the product.**

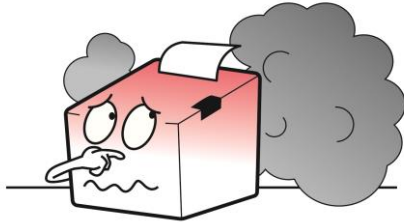

Install the product in a well-ventilated area by keeping it a certain distance from the wall. The product installed in certain places such as where a lot of fine dust is generated, where the temperature is too high or too low, where there is a lot of moisture or water, and at airports or stations that are used continuously for a long time may suffer serious quality problems due to the influence of the surrounding environment. **An increase in internal temperature may start a fire. Be sure to contact the place of purchase before installing the product.**

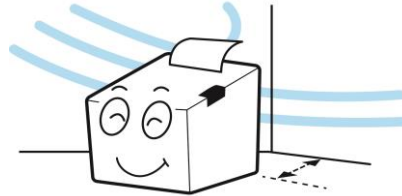

Install the product in a fixed place preventing it from tipping over. When moving the product, turn off the power and disconnect all connected cables, including the power cord. **It may damage the product.**



Never independently disassemble, repair, or modify the product as the warranty will become invalid. **When repair is necessary, contact the original place of purchase.**



Do not let any foreign substances enter the product. Do not place heavy objects, liquids, or metals on the product. **This could cause damage to the product or a fire.**



If there is a problem with the product, please contact the original place of purchase or through BIXOLON website's product repair page ([www.bixelon.com](http://www.bixelon.com)).

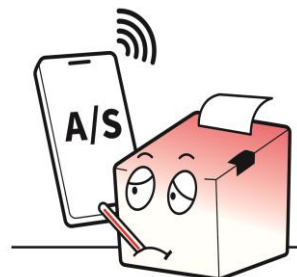

## Manual Introduction

This manual provides basic information on printers and provides ways to install, use, and check them. In order to protect the safety of users and prevent property damage, be fully familiar with this manual before using the product. Please use it.

## Manual Symbol Introduction

	<b>Precaution &amp; Warning</b>	It describes death, physical injuries, serious financial losses, and damage to data etc. that can be caused to the user.
	<b>Note</b>	It provides additional information on the function and performance of the product.

## Product Symbol Introduction

	DC (Direct current)
	Error, Warning
	Paper Feeding
	Stand-By
	USB
	Ethernet



## Printer Introduction

The SRP-S3000 is a premium 3-inch(80 mm) Linerless Printer built with LinerlessPro™ technology. Supporting multiple programming languages including BXL / POS, SLCS™, BPL-Z™ and BPL-C™. The SRP-S3000 provides stable printing for Linerless Extreme, Restick and Liner Label (Gap, Black Mark, Notch, Continuous) media. The standard colour LCD helps users to change the printer setting alongside count pending orders so they can optimise processing operations proactively.

## The main features of the printer are as follows

1. LINERLESS PRINTER
2. Low-noise thermal transfer method printing
3. Maximum 200mm/s printing speed
4. 142 x 210 x 157 (W X D X H)
5. Interface: Serial, USB, Ethernet, WLAN(2.4GHz/5GHz), Bluetooth 5.2
6. Equipped with data buffer (receives print data even while printing)
7. Can print a range of barcodes
8. Range of printing density selectable  
(Controlled with virtual memory switch management)

# Table of Contents

Copyright.....	2
WARNING & CAUTION .....	6
Manual Introduction.....	8
Printer Introduction.....	9
1. Content Confirmation .....	11
2. Product Part Names.....	12
2-1 Printer Part Names.....	12
2-2 Interface Part Names .....	13
2-2-1 USB Interface (Device Function, USB B Type Connector) .....	13
2-2-2 USB Interface (HOST Function, USB A Type Connector) .....	14
2-2-3 Ethernet Interface.....	15
2-2-4 Serial Interface (RS-232C).....	16
2-2-5 Wireless LAN Interface (Option).....	17
2-2-6 Bluetooth Interface (Option) .....	17
2-2-7 Drawer Kick-out Port .....	18
3. Installation & Usage.....	20
3-1 Printer Installation Placings.....	20
3-2 Power on.....	21
3-3 Inserting and changing the paper roll .....	23
3-4 Using Controller.....	26
3-5 Mounting Partition .....	27
4. Printer Setting Change.....	28
5. Self-Test .....	29
6. LCD Menu .....	32
7. Maintenance.....	35
7-1 Paper Jam .....	35
7-2 Cleaning Printer .....	36
8. Specifications.....	37
8-1 Printer Specifications .....	37
8-2 Recommended Papers.....	39

# 1. Content Confirmation



- If there is any part missing, please contact the place of purchase.
- The actual part may look different from the image.

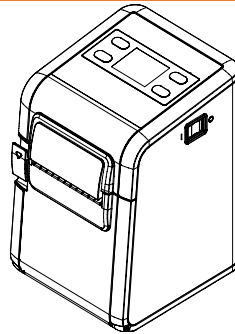

SRP-S3000

## Standard Components

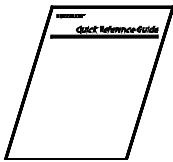

Installation Guide

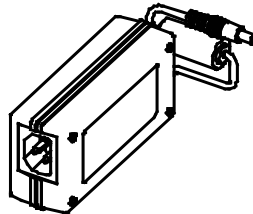

AC/DC Adapter

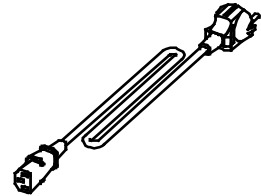

Power Cord

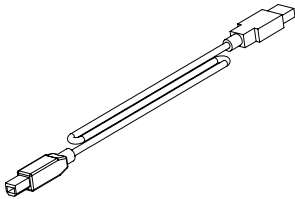

USB A-B Cable

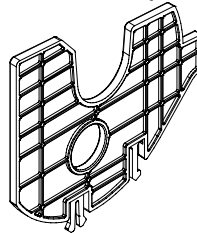

Partition 2ea

## Option Components

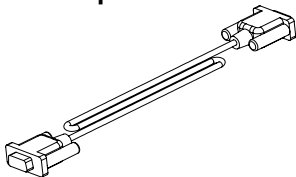

Serial Cable (9pin - 9pin)

## 2. Product Part Names

### 2-1 Printer Part Names



**2-2 Interface Part Names**

- Connect the printer to the host computer using the right interface cable that complies with the specifications of the interface.

2-2-1 USB Interface (Device Function, USB B Type Connector)

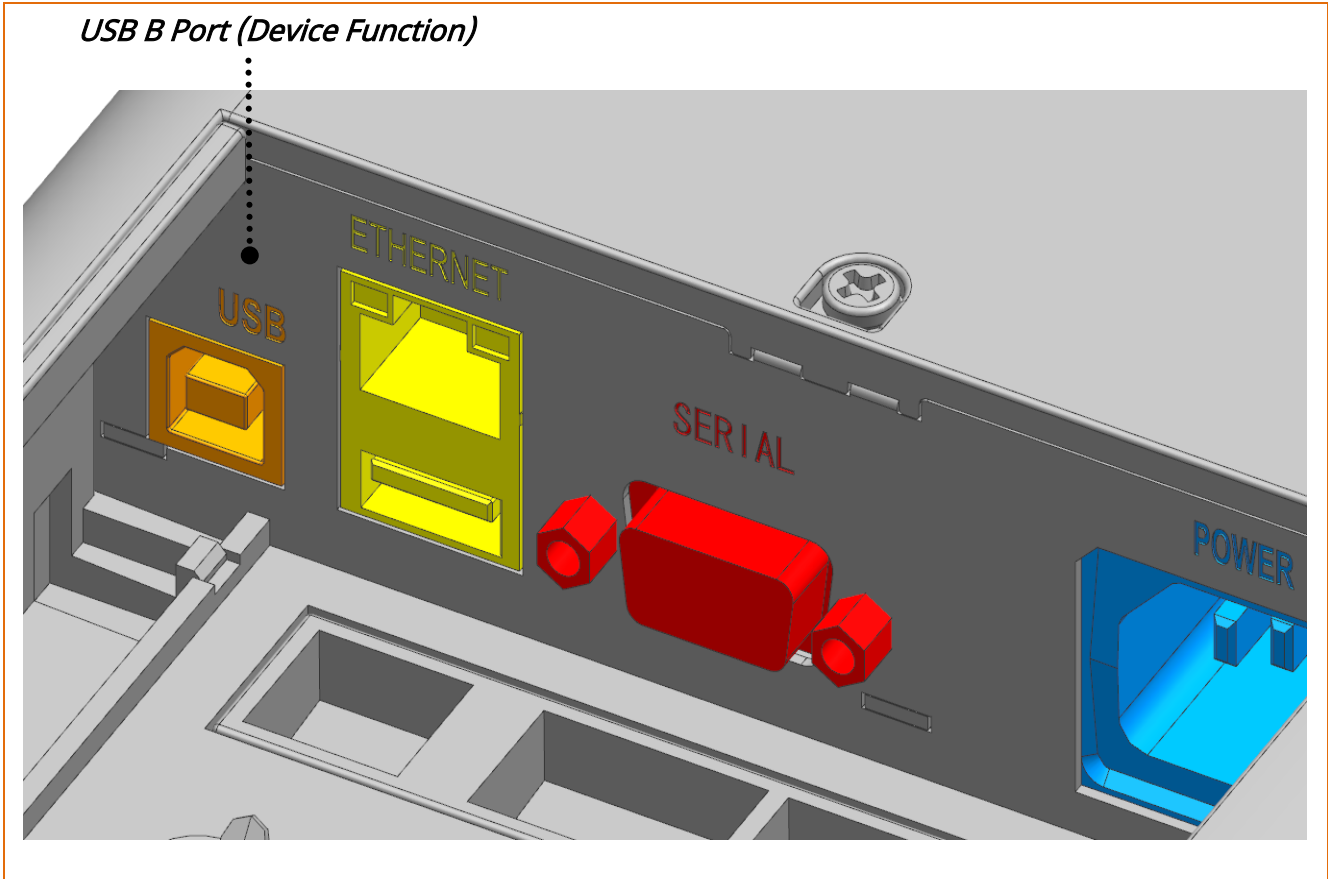

Pin No.	Signal Name	Designation (Color)	Function
Shell	Shield	Drain Cable	Frame Ground
1	VBUS	RED	Host Power
2	D-	WHITE	Data Line (D-)
3	D+	GREEN	Data Line (D+)
4	GND	BLACK	Signal Ground



Connect or disconnect the communication cable while the printer power is off. If power is on, your data may be lost.

2-2-2 USB Interface (HOST Function, USB A Type Connector)

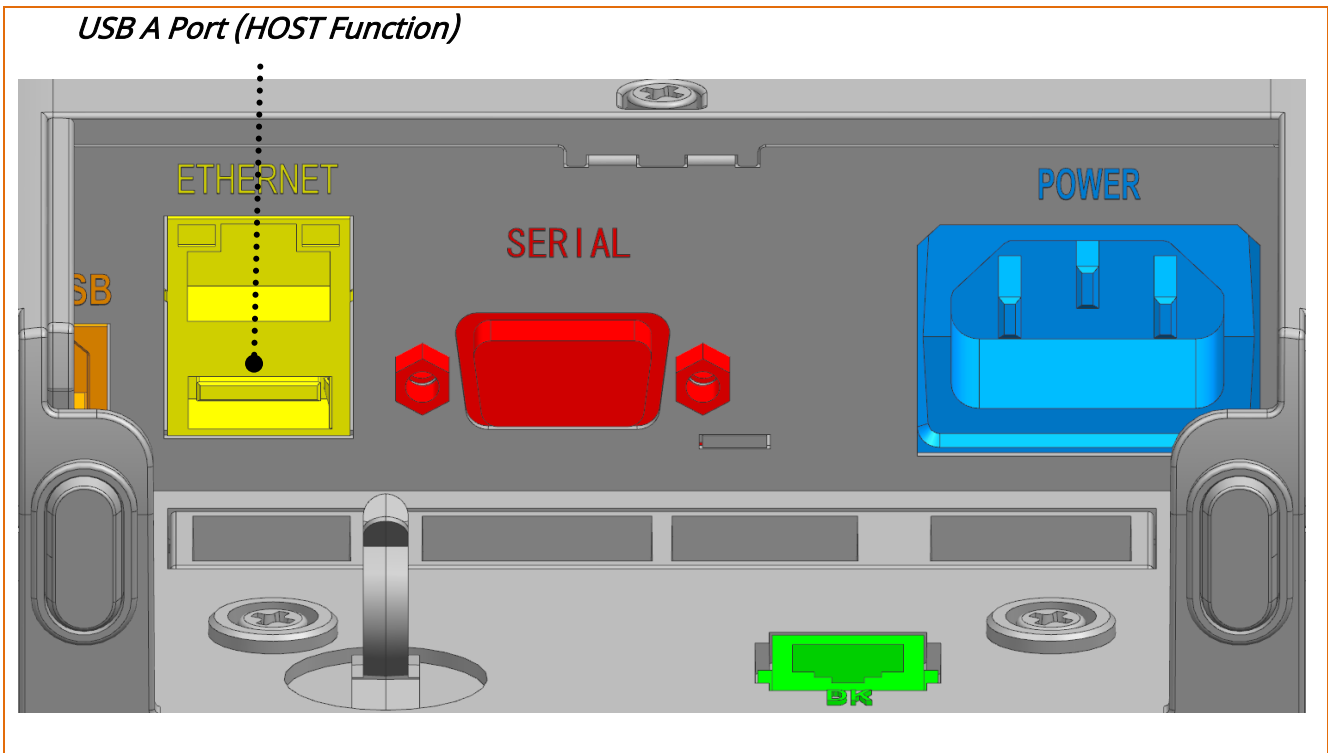

Pin No.	Signal Name	Designation (Color)	Function
Shell	Shield	Drain Cable	Frame Ground
1	VBUS	RED	Host Power
2	D-	WHITE	Data Line (D-)
3	D+	GREEN	Data Line (D+)
4	GND	BLACK	Signal Ground



Connect or disconnect the communication cable while the printer power is off. If power is on, your data may be lost.



- USB Interface can connect to the peripheral devices. (ie. the barcode reader, customer display and WLAN Dongle that is supported by the printer.)
- Do not connect the USB A-A type cable with the Printer and HOST (ex. PC).

2-2-3 Ethernet Interface

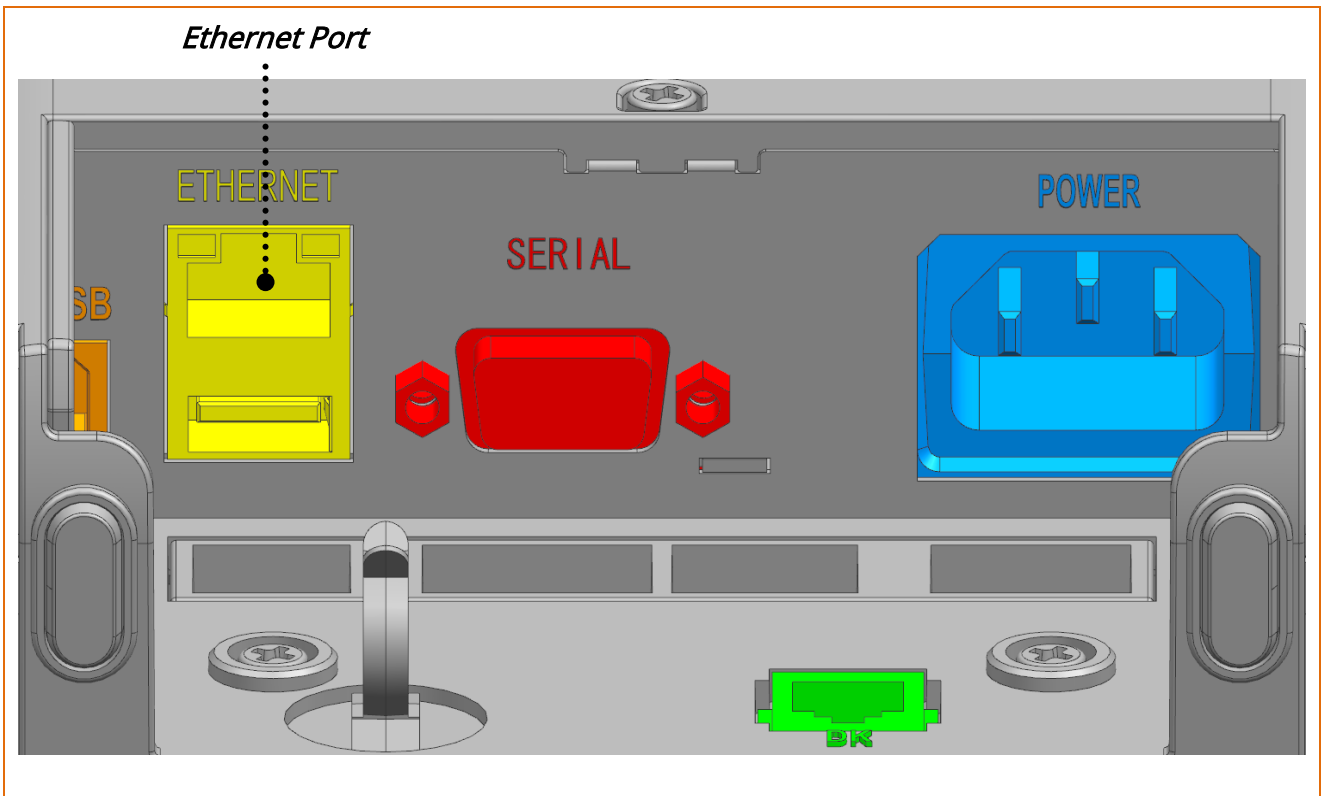

Pin No.	Signal Name	Designation (Color)	Function
1	TD+	WHITE ORANGE	Transmit +
2	TD-	ORANGE	Transmit -
3	CT	WHITE GREEN	Center tap
4	NC	BLUE	-
5	NC	WHITE BLUE	-
6	NC	GREEN	-
7	RD+	WHITE BROWN	Receive +
8	RD-	BROWN	Receive -



Connect or disconnect the communication cable while the printer power is off. If power is on, your data may be lost.



Refer to the Network Connection Manual for more detailed instructions about how to establish the connection. The Network connection manual is on the BIXOLON website ([www.bixolon.com](http://www.bixolon.com)) We're offering it.

2-2-4 Serial Interface (RS-232C)

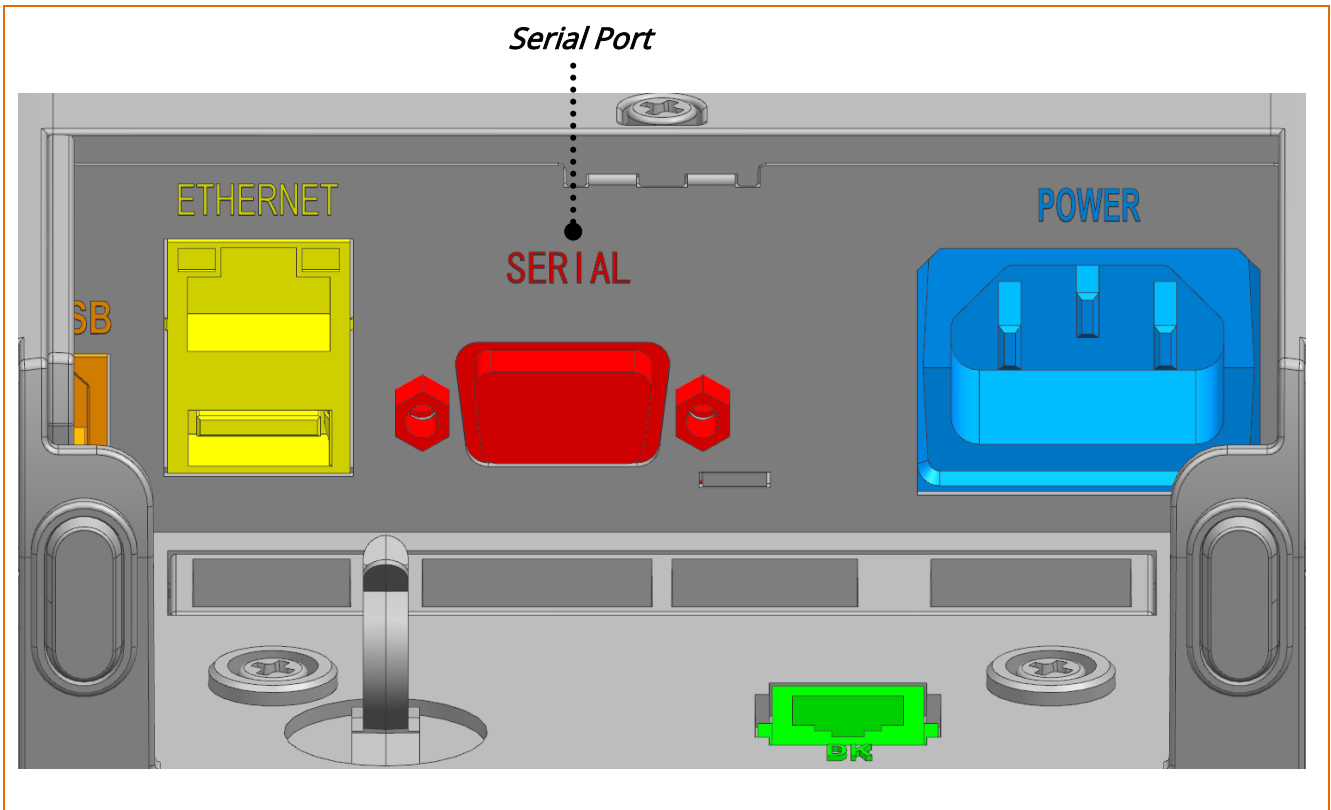

Pin No.	Signal Name	Direction	Function
1	NC	-	-
2	TxD	Output	Transmit Data
3	RxD	Input	Receive Data
6,8	RTS	Output	Ready To Send
4,7	CTS	Input	Clear To Send
5	SG	-	Signal Ground
9	NC	-	-



Connect or disconnect the communication cable while the printer power is off. If power is on, your data may be lost.



2-2-5 Wireless LAN Interface (Option)

1) Wireless LAN Communication Specifications

Item	Specifications
Frequency	2.4GHz / 5GHz
Protocol	802.11 a/b/g/n

2) Connecting Wireless LAN

Printer can be connected to terminal devices with Bluetooth communication Capability. (PDA, PC, smartphone, tablet PC, etc.)



Refer to the Network Connection Manual for more detailed instructions about how to establish the connection. The Network connection manual is on the BIXOLON website ([www.bixolon.com](http://www.bixolon.com)) We're offering it.

2-2-6 Bluetooth Interface (Option)

1) Bluetooth Communication Specifications

Item	Specifications
Frequency	2.402~2.480 GHz
Version	5.2

2) Bluetooth Connection

Printer can be connected to terminal devices with Bluetooth communication Capability. (PDA, PC, smartphone, tablet PC, etc.)



Refer to the Bluetooth Connection Manual for more detailed instructions about how to establish the connection. The Bluetooth Connection manual is on the BIXOLON website ([www.bixolon.com](http://www.bixolon.com)) We're offering it.

**2-2-7 Drawer Kick-out Port**

Connect the Drawer Kick-out cable to the drawer kick-out port on the rear side of the printer.

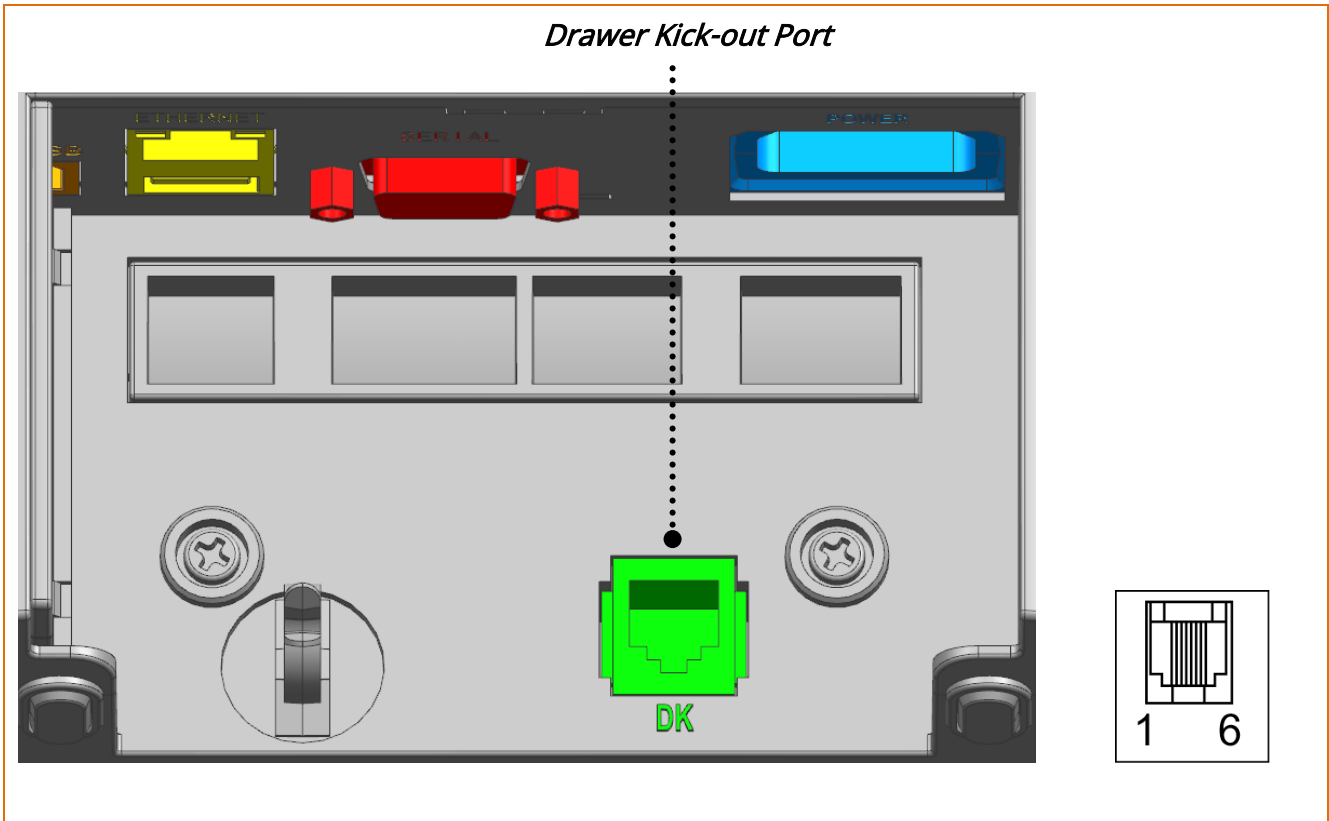

Pin No.	Signal Name	Direction
1	Frame Ground	-
2	Drawer Kick-out Drive Signal 1	Output
3	Drawer Open/Close Signal	Input
4	+24V	-
5	Drawer Kick-out Drive Signal 2	Output
6	Signal Ground	-



- Use a cash drawer that meets the printer specifications. Using a cash drawer that is inappropriate to the specs or Using it as a power supply for a separate device may result in damage to the product
- Do not connect a telephone line to the drawer kick-out port. Otherwise, the telephone line and the computer may be damaged.
- Do not allow a foreign object such as a conductor to touch the drawer kick-out port. This may result in damage to the product.
- Make sure to use a cash drawer with an internal coil resistance of 24  $\Omega$  or higher. (The maximum current is 1A.)
- The open signal time for the cash drawer should not exceed 0.8 seconds. After opening the cash drawer, make sure to idle for at least 3.2 seconds (at least 4 times that of the open signal time) before operating it.

## **3. Installation & Usage**

### **3-1 Printer Installation Placings**

- Allow sufficient space around the printer for proper ventilation.
- Do not place objects close to the back or bottom of the printer, which may hinder the air circulation.
- Install the printer on a flat and level surface.
- Avoid humid environment.
- Install in a place that does not exceed the protocol standard of the wireless communication or the specified maximum distance.
- For stable wireless communication, install in a place where there is no physical obstacle (wall, object, etc.).

3-2 Power on

1) After turning the printer off, connect the Power cord jack to the printer's power port.

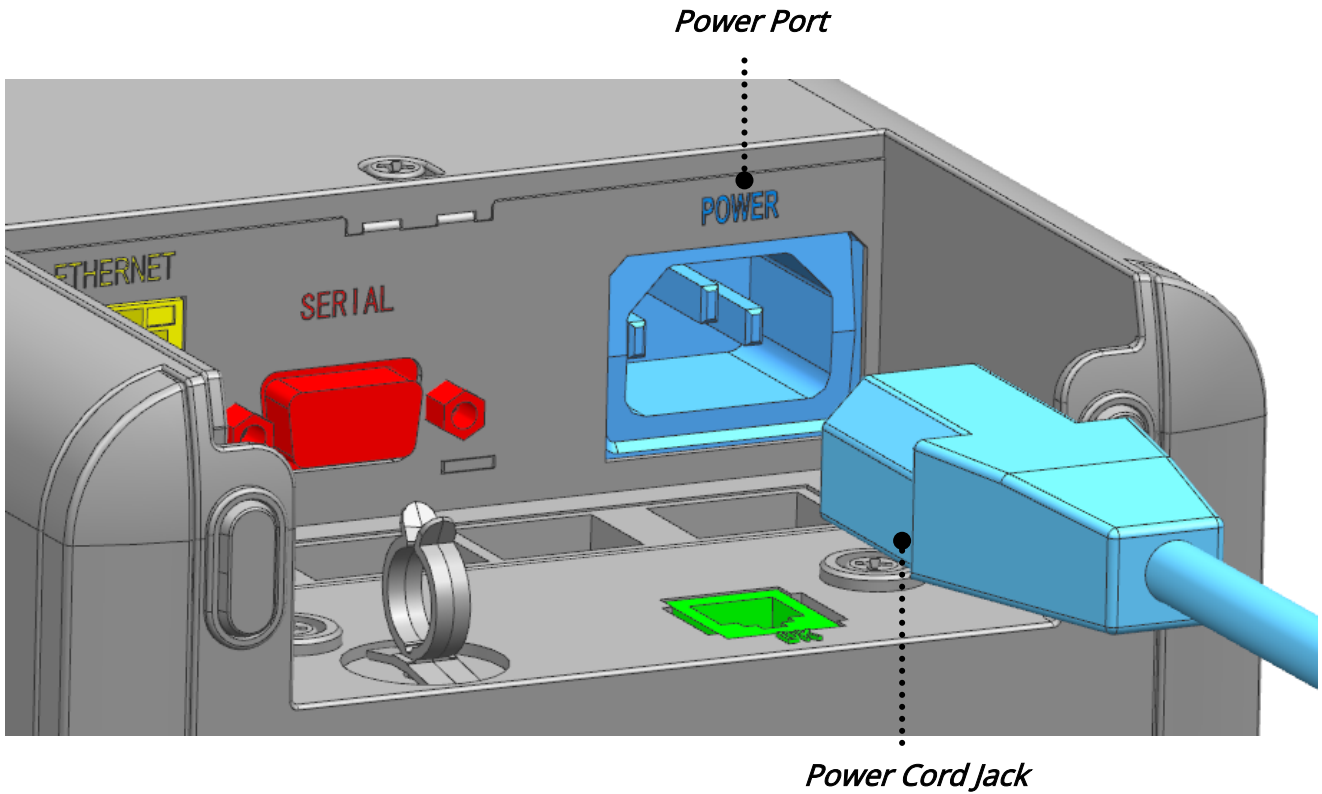

2) When connecting the power cord jack, ensure that it is inserted in the correct direction.

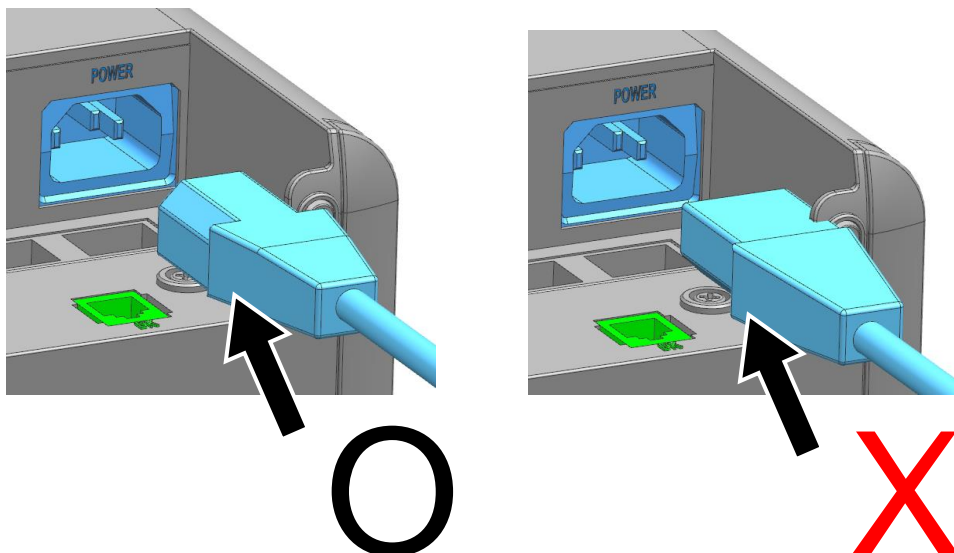

3) Plug it into the power outlet on the wall.

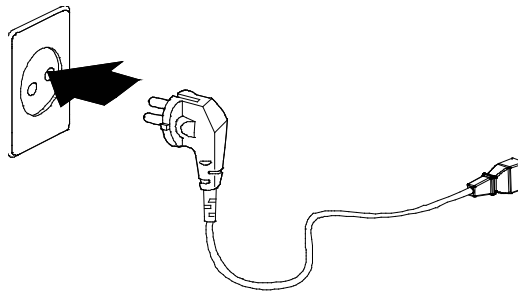

4) Press the "ON" switch to turn on the printer.



- Check the power supply's label to check its electronic specs.
- Only use a power supply provided by BIXOLON. BIXOLON shall bear no responsibility for damage caused by using a third-party power supply.
- Pay attention to the direction in which you insert the power jack.
- When removing the power supply, make sure you have a firm grasp of the plug terminal of the power jack and the printer and pull horizontally.
- When connecting or disconnecting power, make sure to remove the power supply from the power outlet before removing.
- Do not connect a voltage out of the specifications of the power supply. It can cause damage to the product or a fire.

### 3-3 Inserting and changing the paper roll



Use paper roll that complies with the specifications

If you use a paper roll including paper core attached to paper, the paper may not be properly recognized as paper Empty due to not proper releasing of paper.



- When opening or closing the cover, be careful not to pinch your fingers.
- Do not open the print head levers while the printer is printing. The printer may be damaged.
- Change the paper when the printer is not receiving data, or data may be lost.
- While the printer is operating, the printer head gets very hot, so turn off the power and let it cool down completely. The hot printer head can cause serious burns.

1) Open the paper roll cover by Pulling the Cover-Open Lever.

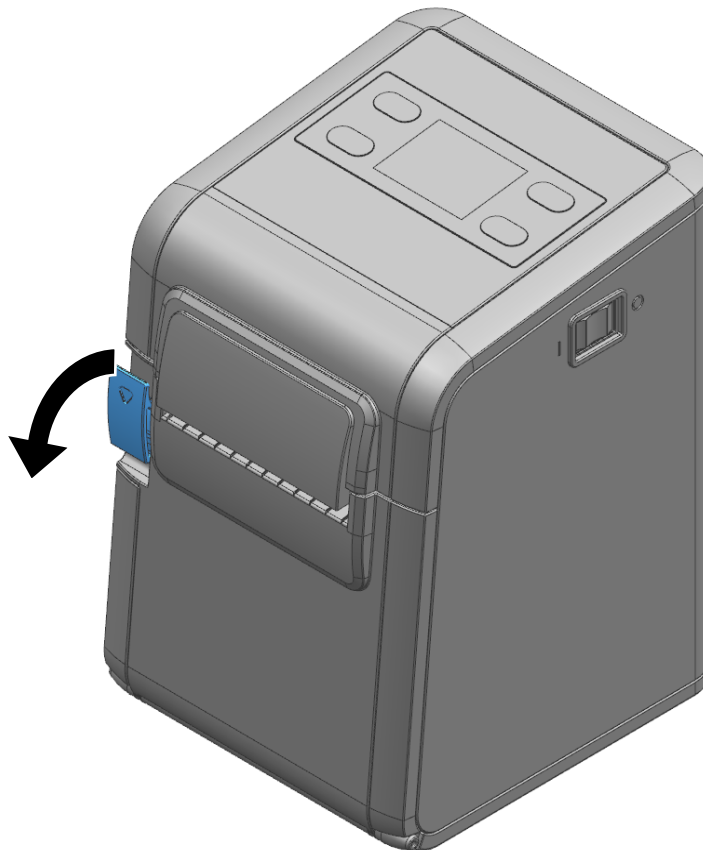

When you change the paper, remove the used paper roll.

2) Replace with a new one as shown in the image.

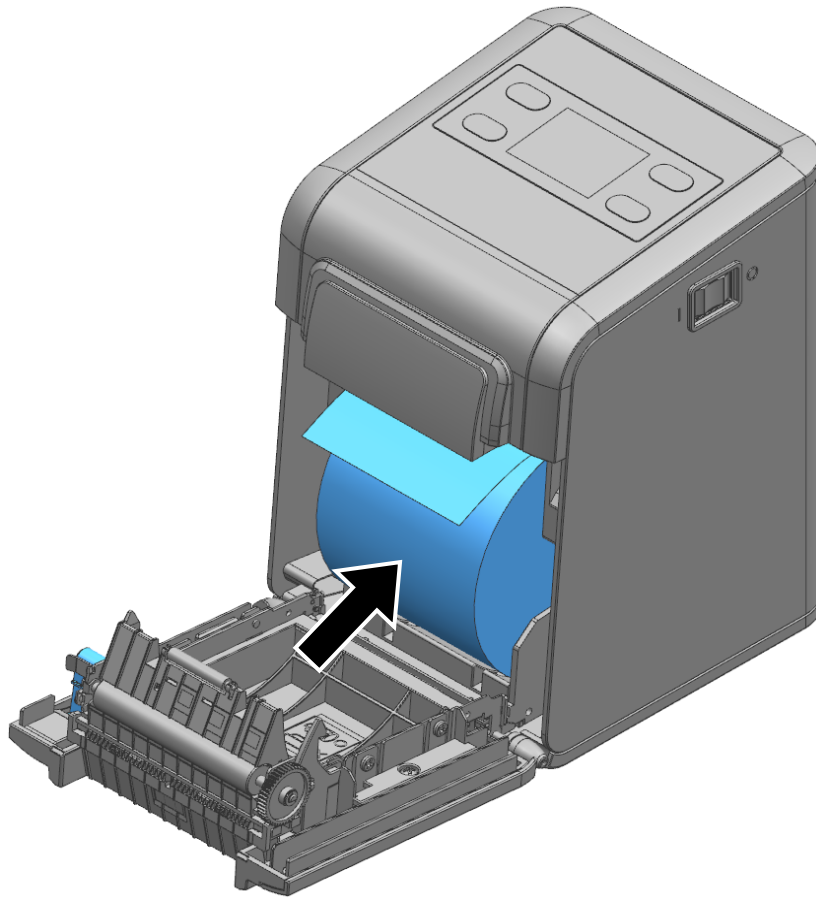

3) Check the orientation of the roll paper when inserting it into the printer.

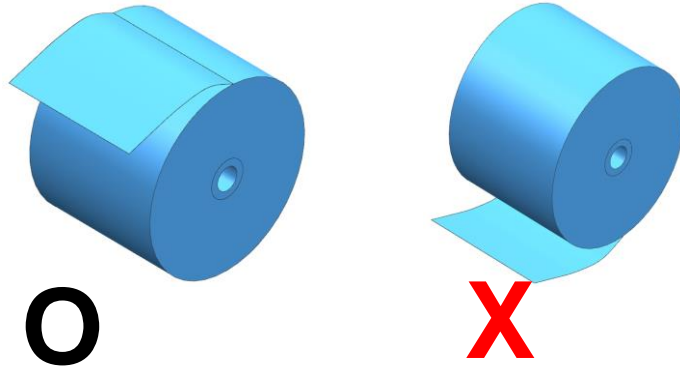





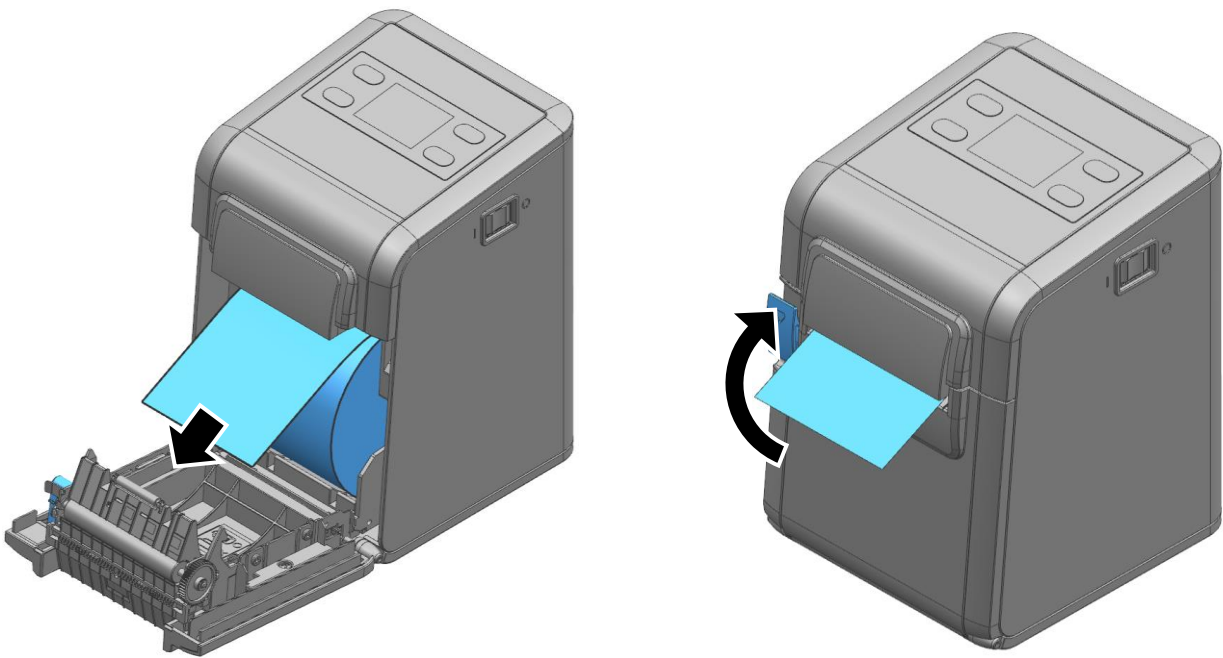

4) Pull out a small amount of paper as shown in the picture, and close the Printer Cover.

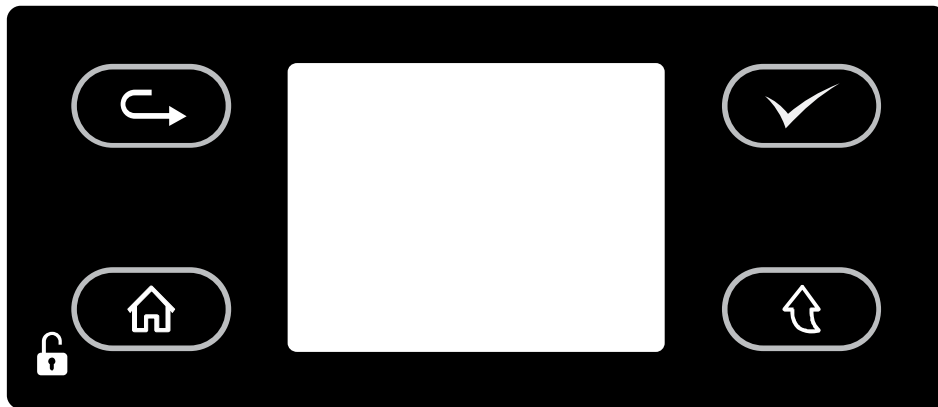

When closing the Printer Cover, hold down the center of printer cover firmly so that paper roll is loaded correctly.

3-4 Using Controller



Explanation		
	Menu Navigation	Navigate the LCD menu - Press the button to navigate from the top-left to the bottom-right corner.
	Menu Select	Select an item in the LCD menu - Press the button to select an LCD menu item or save the settings to the printer.
	Home & Unlock	Return to the LCD main menu/activate a function - While navigating the LCD menu, press this button to return to the main menu or activate a selected item. - Hold the button to unlock the system. (2 seconds)
	Feed	Feed media or return to the previous menu - Hold this button while the printer boots up to print a self-test page. - Once booted up, press this button to feed media. - In the LCD menu, press this button to return to the previous menu.



Use LCD function or virtual memory switch utility to change and check printer settings. For more information, refer to the "6.LCD Menu" and Utility Manual in the User Manual.

**3-5 Mounting Partition**

• The Partition shape is the same and is used separately for each paper size (40,58mm).  
The position to secure the partition varies depending on the type of paper.

1. 58mm (2-inch) roll paper: mount 1 partition at Position #1.
2. 40mm roll paper: mount 2 partitions at Positions #1 and #2.

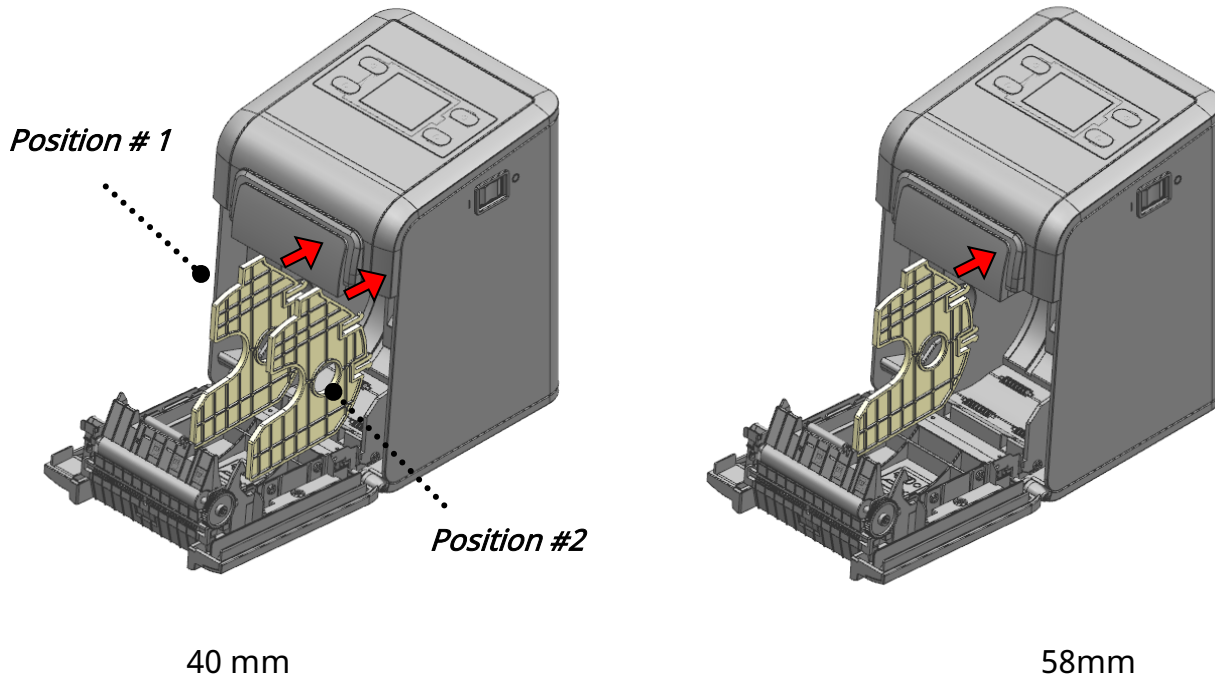

After using narrower papers (e.g. 40, 58 width) than the maximum paper width of 80mm, please do not use any wider ones as it might affect printing quality due to uneven platen roller abrasion.



The shape of the partition is the same for each type of roll paper.

## 4. Printer Setting Change

Use the Unified Utility or LCD to change the virtual memory switch settings.



- Turn the product power ON/OFF by using the virtual memory switch utility.
- For more details, please refer to Utility and [6. LCD Menu].

## **5. Self-Test**

The self-test checks whether the printer has any problems.

If the self-diagnostics reveal no error in the printer, please see other device or software.

If the printer does not run normally, please contact the place of purchase.



**- Do not open the top cover while the printer is running.  
It may damage the printer.**

**- If the printer does not run normally, please contact Customer Center.**

### **How to self-test**

- 1) Turn on the printer. Go to Tool > Print Printer Settings on the LCD screen.
- 2) Press the Home button (Print) to start self-testing.
- 3) The printer settings will be printed on the first page followed by interface information.
- 4) The self-test process ends automatically after printing wireless interface information.

• Self-test print page sample

---

BIXOLON SRP-S3000 CONFIGURATION

---

FIRMWARE VERSION : V01.00 STD 010118  
EMULATION : SLCS & BPL-Z & BPL-C  
PRINT DARKNESS : 0/30  
PRINT SPEED : 5 IPS  
TEAR OFF VALUE : +000 DOT  
TEAR OPTION : TEAR-OFF  
PRINT OFFSET : +0000 DOT  
POWER-UP ACTION : NO ACTION  
MEDIA TYPE : BLACKMARK MEDIA(REAR)  
SENSOR TYPE : REAR REFLECT  
PRINT METHOD : DIRECT THERMAL  
LABEL LENGTH : 1013 DOT  
LABEL WIDTH : 576 DOT  
BAUD RATE : 115200  
PARITY : NONE  
DATA BIT(S) : 8  
STOP BIT(S) : 1  
HAND SHAKING : HARDWARE  
USB SERIAL NUMBER : 0000000000001  
BPL-Z CODEPAGE : CP-850(SBE. USA-1 CHARSET)  
SLCS CODEPAGE : WCP1252-LATIN1  
SLCS ICS : U.S.A

---

CONFIGURATION CONTROL STATUS

---

PRINT SPEED : COMMAND  
PRINT DARKNESS : COMMAND  
PRINT WIDTH : COMMAND  
PRINT OFFSET : COMMAND  
TEAR OFF : COMMAND  
MEDIA TYPE : COMMAND  
LANGUAGE : COMMAND

---

---

RF INTERFACE STATUS (BT)

---

BLUETOOTH F/W VER : 2.0.4  
MAC ADDRESS



74F07DE3D121

FRIENDLY NAME : SRP-S3000  
MODE : CLASSIC  
AUTH & ENCRYPT : ENABLED  
CONNECTION MODE : 2

**(Bluetooth)**

---

RF INTERFACE STATUS (WLAN)

---

WLAN F/W VER : 02.02(4002)  
MAC ADDRESS



74F07DE3D121

SYSTEM NAME : SRP-S3000  
NETWORK MODE : SOFT AP  
FREQUENCY : (PRIORITY)2.4GHZ/5GHZ  
AUTHENTICATION : OPEN  
ENCRYPTION : NONE  
ESSID : PRINTER\_E3D121  
DHCP : DISABLED  
IP ADDRESS : 192.168.1.1  
NETMASK : 255.255.255.0  
GATEWAY : 192.168.1.2  
PORT : 9100  
INACTIVITY TIME : 10 SEC











**(WLAN)**

## 6. LCD Menu

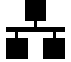
You can check the printer's status and settings on the LCD screen.











### • Icons on top

Icon	Description
	Bluetooth enabled, host device not connected
	Bluetooth enabled, host device connected
	Wireless LAN enabled, wireless LAN signal strength
	Wireless LAN enabled, AP not found
	Wireless LAN enabled, AP connection authentication error
	Wired LAN enabled
	Data reception, print, media transfer
	No media
	Media cover open
	TPH overheated
	Key locked



• Main menu icons

Icon	Description
	<p>View/change printer settings</p> <ol style="list-style-type: none"> <li>1) Communication</li> <li>2) Media</li> <li>3) Sensor</li> <li>4) Language</li> <li>5) Sound</li> <li>6) Brightness</li> </ol>
	<p>Media settings</p> <ol style="list-style-type: none"> <li>1) Print speed</li> <li>2) Print density</li> <li>3) Headlock</li> <li>4) Position <ul style="list-style-type: none"> <li>- Cut</li> <li>- Printing position</li> <li>- Orientation</li> </ul> </li> </ol>
	<p>Tool</p> <ol style="list-style-type: none"> <li>1) Hex dump</li> <li>2) Print printer settings → Self-test</li> <li>3) Print test pattern</li> <li>4) Factory reset</li> <li>5) TPH cleaning mode</li> <li>6) Emulation mode</li> </ol>
	<p>View/change interface settings</p> <ol style="list-style-type: none"> <li>1) Bluetooth <ul style="list-style-type: none"> <li>- SSP (Secure Simple Pairing) / PIN code</li> <li>- BLE / Classic mode</li> <li>- Information (name, MAC address)</li> </ul> </li> <li>2) Wireless LAN <ul style="list-style-type: none"> <li>- Information (SSID, Mode, encryption, IP, port, MAC address, inactivity time)</li> <li>- Smart connection (use APP to connect to AP)</li> <li>- Factory reset</li> </ul> </li> <li>3) Wired LAN <ul style="list-style-type: none"> <li>- IP address, port</li> </ul> </li> <li>4) Serial <ul style="list-style-type: none"> <li>- Set baud rate</li> <li>- Set data bit, parity, flowcontrol</li> </ul> </li> </ol>

Icon	Description
	<p>Taken sensor settings</p> <ol style="list-style-type: none"> <li>1) Turn ON/OFF Taken sensor</li> <li>2) Set Taken sensor operation pages</li> </ol>
	<p>Printer information</p> <ol style="list-style-type: none"> <li>1) Version <ul style="list-style-type: none"> <li>- Printer, WLAN, Bluetooth</li> </ul> </li> <li>2) Bluetooth</li> <li>3) Wireless LAN</li> <li>4) Wired LAN</li> <li>5) Serial</li> <li>6) Use</li> <li>7) Repair</li> </ol>
	<p>View/change sensor settings</p> <ol style="list-style-type: none"> <li>1) Media type <ul style="list-style-type: none"> <li>- Auto-detect / Black mark / GAP</li> <li>- Continuous media</li> </ul> </li> </ol>
	<p>LCD screen locked</p>

## 7. Maintenance

### 7-1 Paper Jam

• If paper is stuck, turn the printer ON/OFF and open the Printer Cover to remove the crumpled paper inside the printer. If the cover will not open, please follow the following instructions.

- 1) Turn the printer OFF.
- 2) Pull out the Cutter Cover to separate from the printer.
- 3) Turn the knob and insert the blade that sticks out using a cross-head screwdriver as shown below.
- 4) Push the Cover Open Button and remove the jammed paper.
- 5) Put the Cutter Cover back in place.
- 6) Turn the Printer Cover ON and use it.

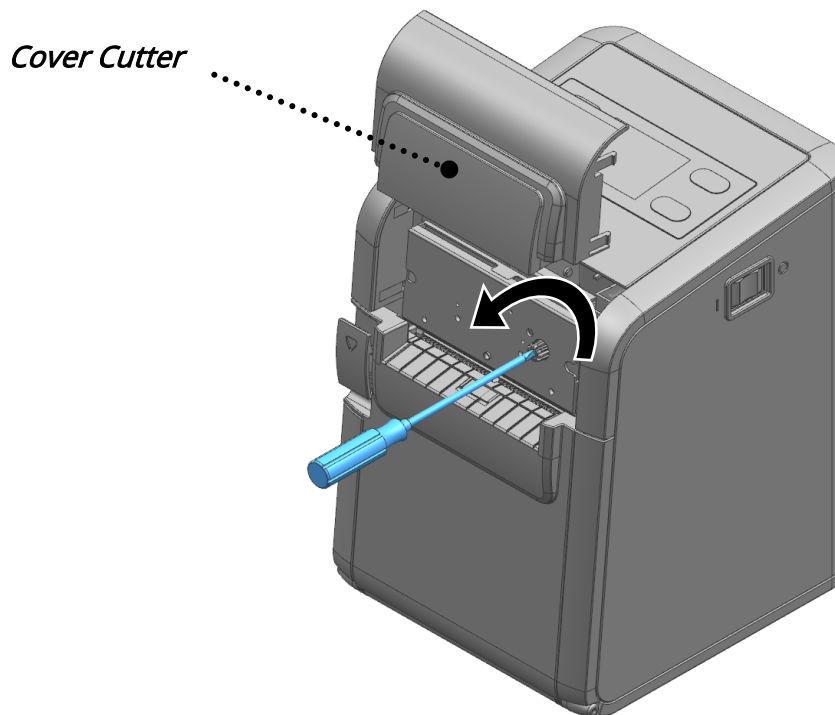

If the cover does not open, do not forcibly open it.  
It may result in poor paper cutting or printer damage.



- Placing your hand above the printer outlet may cause a paper jam.
- In case of a minor jam, it may be possible that the operating blade returns to the original position by turning the printer OFF and then back ON.

**7-2 Cleaning Printer**

- The presence of dust, foreign matter, adhesive matter, or other pollutants inside the printer's head and internal capacity may undermine printing quality. Periodic cleaning (every 3 months at minimum) is recommended to maintain print quality. It is recommended to clean after every 30 rolls when using Sticky, Re-stick, Linerless Extreme paper.

- 1) Open the printer cover and remove the paper currently in use.
- 2) Residue or contamination of printer head should be wiped out by alcohol for medical.
- 3) Clean the paper sensor and paper roller with a cotton swab or a dry cloth.
- 4) Insert a paper roll and close the printer cover.

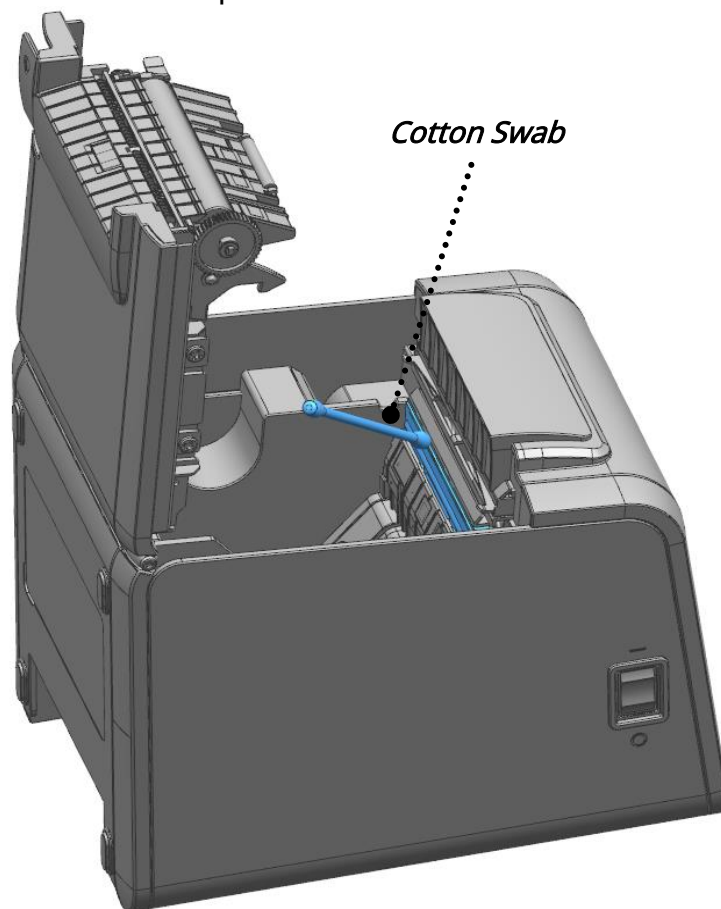

- Be sure to clean after turning the printer off.
- Be careful not to leave scratches in the print head  
The printer may be damaged.
- Print head is very hot while the printer is printing, so clean the printer after cooling it sufficiently with power off.
- Do not touch heated area of print-head when cleaning.  
Personal injury may result from static electricity, etc.

## 8. Specifications

### 8-1 Printer Specifications

Printing Method	Thermal printing	
Dot Density	203 dpi (8dots/mm)	
Paper Width	72mm, 48mm, 32mm	
Printing Width	80mm, 58mm, 40mm	
Application	BXL/POS	SLCS, BPL-Z™, BPL-C™
Font	Font A : 12x24(48CPL) Font B : 9x17 (64CPL) Font C : 9x24 (64CPL)	10 SLCS Resident Bitmap Fonts One SLCS Resident Scalable Font 16 BPL-Z™ Resident Bitmap Fonts One BPL-Z™ Resident Scalable Font 7 BPL-C™ Resident Bitmap Fonts 23 Code Page Unicode supported (UTF-8, UTF-16LE, UTF-16BE)
Bar Code	1D: Codabar, Code 11, Code 39, Code 93, Code 128, EAN-13, EAN-8,Industrial 2-of-5, Interleaved 2-of-5, Standard 2-of-5, UPC-A, UPC-E  2D:, Data Matrix, PDF417, QR code	1D: Codabar, Code 11, Code 39, Code 93, Code 128, EAN-13, EAN-8, Industrial 2-of-5, Interleaved 2-of-5, Logmars, MSI, Plessey, Postnet, GS1 DataBar (RSS-14), Standard 2-of-5, UPC/EAN extensions, UPC-A, UPC-E, IMB 2D: Aztec, Codablock, Code 49, Data Matrix, MaxiCode, MicroPDF417, PDF417, QR code,TLC 39
Sensor	Gap Sensor, Black Mark Sensor, Taken Sensor, Cover Switch	
Cutting Type	Auto Cutter	
Printing Speed	Max. 200 mm/sec	
Receiving Buffer Size	64KB Byte	

Interface		S3000K: Serial, USB, Ethernet S3000BaK: Serial, USB, Ethernet, Bluetooth 5.2 S3000WDaK: Serial, USB, Ethernet, WLAN (2.4GHz, 5GHz)
Drawer Kick-out Port		2ports (with Y-type cable)
AC/DC Adapter	Input Voltage	100~240 VAC
	Frequency	50/60 Hz
	Output Voltage	24 VDC
Environment Condition	Temperature	Operating: 0 ~ 40 °C Storage: -20 ~ 60 °C
	Humidity	Operating: 10 ~ 80 % RH Storage: 10 ~ 90 % RH Paper excluded
Life Span	Printer Head	Label: 30 Km Restick, Linerless Extreme: 100 Km
	Auto Cutter	Label, Linerless Extreme: 300,000 Cuts Restick: 1,000,000 Cuts



The specifications were determined based on operation at normal temperature using designated paper on default settings. They are subject to change depending on temperature or printing level. Printing speed may become slightly slower depending on the data transmission speed and the combination of commands.

**8-2 Recommended Papers**

- Iconex

Classic: 9023-1253, 9023-1232(80mm), 9023-1823, 9023-1397(58mm),  
9023-1233, 9023-1818(40mm)

Classic High Tack: 9023-1254(80mm), 9023-1500(58mm), 9023-1258(40mm)

Classic High Temp: 9023-1267, 9023-1463 (80mm), 9023-1269(40mm)

Ultralite: 9023-1866(80mm), 9023-1410(58mm), 9023-1865(40mm)

Classic High Tack Plus: 9023-1846(80mm)

Linerless Extreme (Snag Resistant): 9023-1873, 9023-1708(40mm)

Linerless Extreme (Freshness Labeling): 9016-3227, 9016-3777, 9016-3257(40mm)

- MAXStick

2GO: MS2142402GO3S(58mm), MS3182402GO4S(80mm)

PLUSD: MS1732290PLUSD HVHR (40mm), MS214170PLUSD (58mm), MS318170PLUSD  
(80mm), MS3183752GOPLUSD (80mm)

X2: MS11732270X2HRHT (40mm), MS214150X2(58mm)

- StickyPOS

40MMRL90-9000(40mm), 2CR-11 58X350(58mm) 2CR-11 80X350(80mm)

- Sato

Restick: 585006411(80mm)

Linerless Extreme: 585006451(80mm)

- Blumberg

Linerless Extreme: A11649(58mm), A12978(80mm)



- The use of papers other than those recommended above may cause damage to the printer's TPH or degrade the printing quality. BIXOLON is not responsible for the damage caused by non-recommended papers.
- If you have to use other products, we recommend that you use papers with a similar level of quality to the recommended ones.

# Revision history

Ver.	Date	Description
1.00	28-01-2021	New
1.01	20-08-2021	Add Authentication Statement (Wireless Communication)
2.00	06-11-2023	New Form
2.01	18-03-2025	Modify '7-2. Cleaning Printer' text